

New

Star Back

Future Mobility Healthcare Inc., manufactures and markets products that increase the freedom and safety of mobility challenged individuals. Reliable for quality and service, Future Mobility Healthcare Inc. provides high quality and innovative mobility products to the home healthcare market.



The Prism™ Star Back was specifically designed for users who require complex postural support and comfort. The Star Back's unique air adjustable cell design, offers maximum protection, positioning and stability .

The ability to customize the Back to each individual's needs and the exclusive Prism hardware allow for easy adjustment and installation.

Combine this with Prism's sleek and attractive tailored look for a Back that will appeal to a wide variety of users!

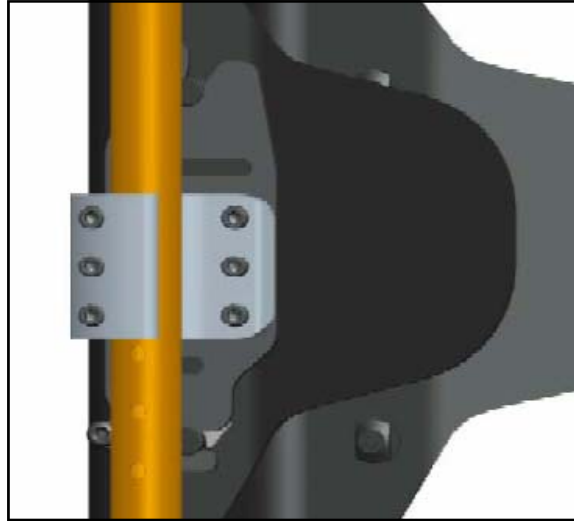

SPOTLIGHT ON

- Lightweight, sturdy aluminum shell
- Seat angle adjustment from 82 degrees to 114 degrees optimizing users' positioning
- Low maintenance air filled cells
- Choice of 2", 3" and 4" cell heights for individual clients needs
- Attractive cover design
- Cane clamps included

WARRANTY

Three (3) years limited on Back and 90 days on cover, 1 year on hardware.

PRODUCT WEIGHT

5lbs

USER WEIGHT

Unlimited

Stock Sizes - Shipments within 3 Business Days

16" x 16"	SB1616
18" x 16"	SB1816
20" x 16"	SB2016
16" x 20"	SB1620
18" x 20"	SB1820
20" x 20"	SB2020

Non-Stock Sizes - Shipments within 7 Business Days

14" x 14"	SB1414
16" x 18"	SB1618
18" x 18"	SB1818
20" x 18"	SB2018

*Custom orders will rarely be turned away.....
we can accommodate as low as 11" in back height
and ship it within 10 days!*

